

INSTALLED BY: TRESSLER PLUMBING  
DATE INSTALLED: 11-30-07  
INSPECTED BY: MARTY CROSSLAND

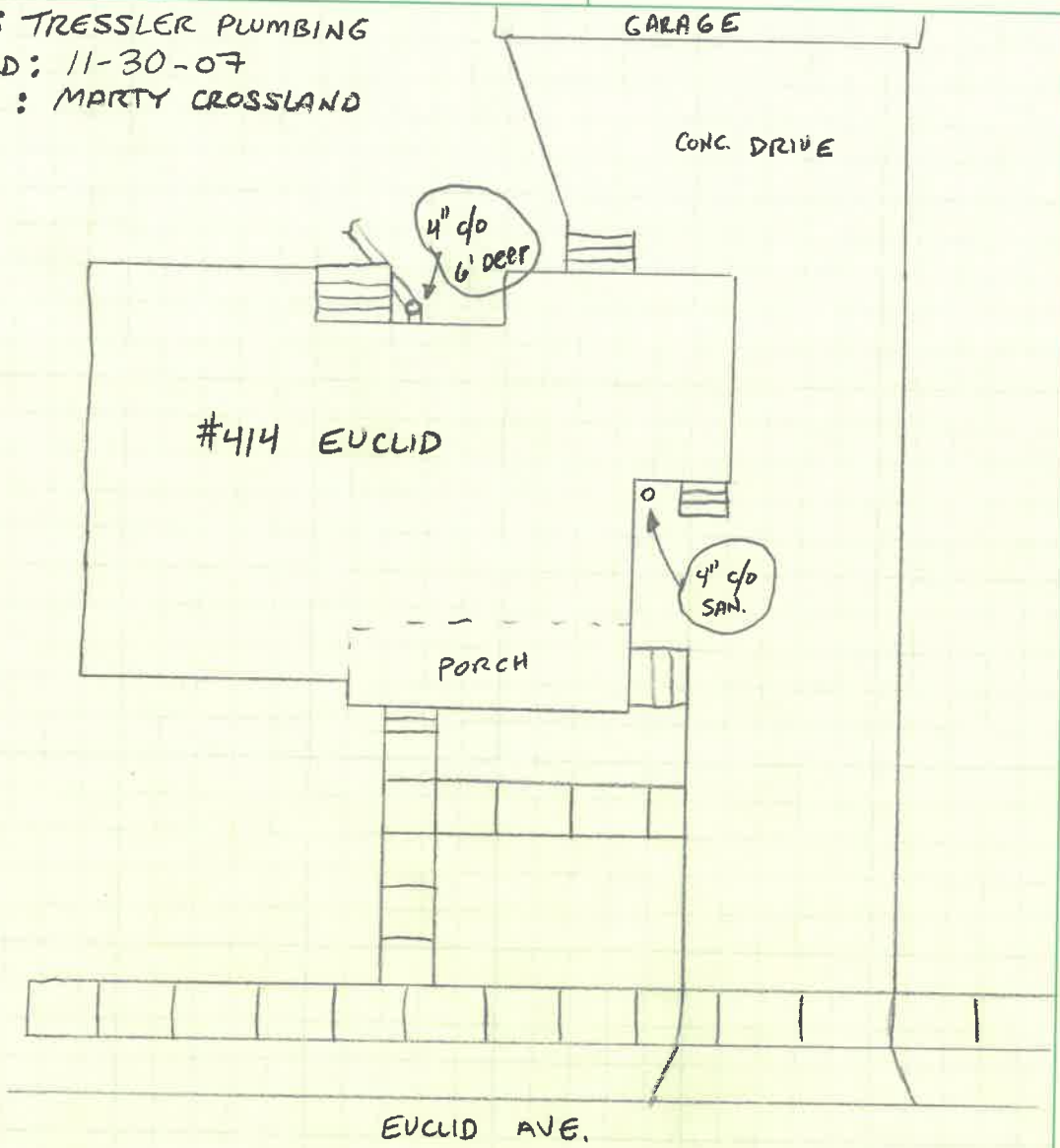

PLAN DETAIL

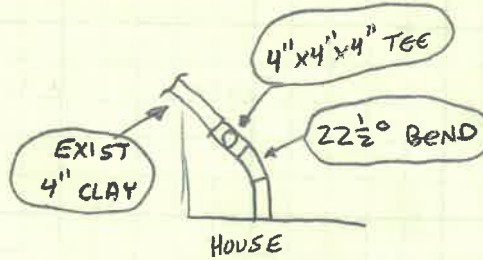

PROFILE DETAIL

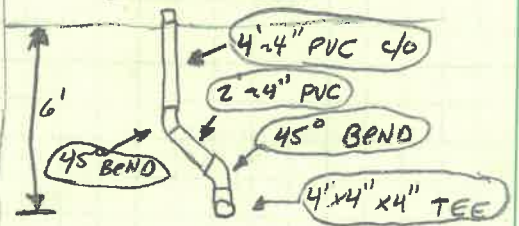

INSTALLED BY: TRESSLER PLUMBING  
DATE INSTALLED: 11-30-07  
INSPECTED BY: MARTY CROSSLAND

GARAGE

CONC. DRIVE

#414 EUCLID

4" c/o  
6' DEEP

4" c/o  
SAN.

PORCH

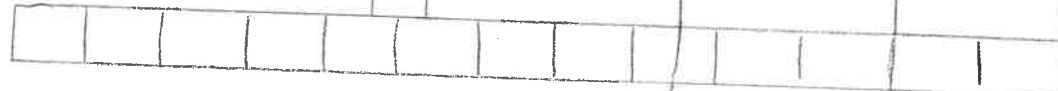

EUCLID AVE.

PLAN DETAIL

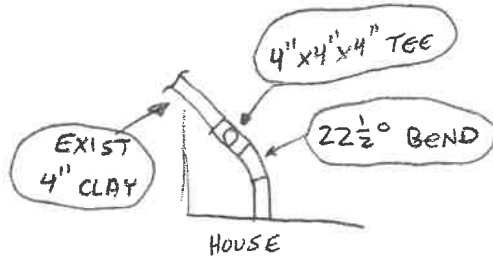

PROFILE DETAIL

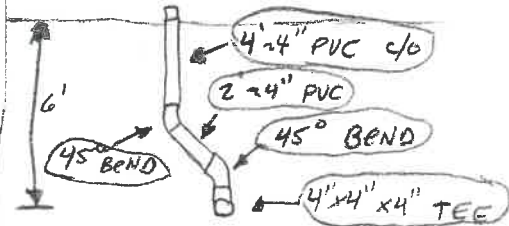

STAEDTLER® No. 937 811E  
Engineer's Computation Pad